

Essential-5 Keystone Connector

ESSENTIAL-5 KEYSTONE CONNECTOR CAT 5E UNSCREENED

Aginode Ref: N420.415

- Complies with the latest Category 5e standards
- Unscreened
- Fast termination from either side or rear
- Fits in all Aginode keystone hardware designed for Essential-5 and -6
- 110 or LSA+ termination

Application

The Aginode Essential-5 keystone connector is manufactured and tested to the latest Category 5e specifications. It supports Class D applications up to 100 MHz. When installed in conjunction with Essential-5 cable and patch panels, a 25 year Class D Link Warranty can be obtained from the Aginode web site.

Design

The Essential-5 keystone connector is designed to match with Essential-5 cable and patch cords and complements all Essential modular components, such as:

- keystone patch panels (black and white)
- keystone outlet modules (UK, US and European formats)

Please follow the links on this page to view the related datasheets.

The modular jack is designed for keystone footprints of 14.78 mm width, 20-20.78 mm height and 1.5 mm wall thickness and is compatible with a variety of keystone formatted structural hardware. (Please check compatibility with Aginode before using 3rd party hardware)

Performance

The Essential-5 keystone connector is compliant with the specifications of ISO/IEC 11801 and EN 50173.

Installation

- Cable entry from either side or rear.

All drawings, designs, specifications, plans and particulars of weights, size and dimensions contained in the technical or commercial documentation of Aginode is indicative only and shall not be binding on Aginode or be treated as constituting a representation on the part of Aginode.

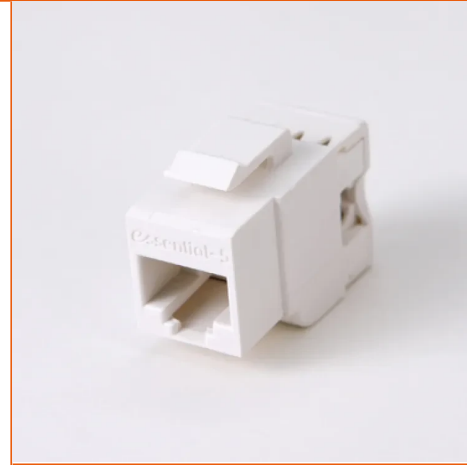

STANDARDS

ISO/IEC 11801

- Wiring according to colour code T568B or T568A.
- Termination with 110 or LSA+ punchdown tool.
- Accepts 24, 23 and 22 AWG solid core cables.
- Fits Aginode hardware designed for keystone format.

Dimensions Essential-5 Keystone connector

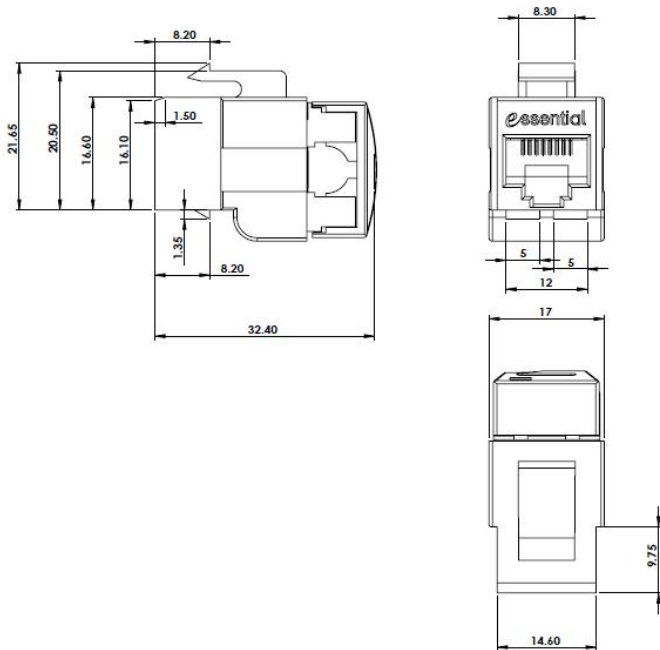

All drawings, designs, specifications, plans and particulars of weights, size and dimensions contained in the technical or commercial documentation of Aginode is indicative only and shall not be binding on Aginode or be treated as constituting a representation on the part of Aginode.

Essential-5 Keystone Connector Cat 5e Unscreened

Eigenschaften

Konstruktionsmerkmale

| | |
|--------------|-----------------------|
| Farbe | weiss |
| Schirm | Unshielded |
| Verbindertyp | RJ45 and 110/LSA+ IDC |

Abmessungsmerkmale

| | |
|--------|---------|
| Tiefe | 32.4 mm |
| Höhe | 21.6 mm |
| Breite | 17 mm |

Anwendungsmerkmale

| | |
|--|-------------|
| Bereich | essential |
| Betriebstemperatur | -20...60 °C |
| Kategorie | Cat. 5e |
| Komponentenfunktion | Connector |
| Lagertemperatur, Bereich | -20...60 °C |
| Umgebungstemperatur bei Verlegung, Bereich | -10...60 °C |